

Mobile 2-Post Lift FHB® 3000

Accessory



Ascending Device FA-TORO

(Art.-No. FHB3000-03FATORO)

Use

For mowing machines and golf buggies.

Accessory for car lift FHB3000-SS-2300 with an extended drive-in width of 2300 mm.

Art.-No. of the corresponding lift:
FHB3000-SS-2300 – Art.-No.FHB3000-03

Technical data (car lift with FA-TORO)

| | |
|-------------------|---------------------------------------------------|
| Capacity: | 2750 kg |
| Load support: | 4 wheel support pads, 370 x 350 mm, adjustable |
| Access height: | 100 mm |
| Weight of device: | 120 kg |

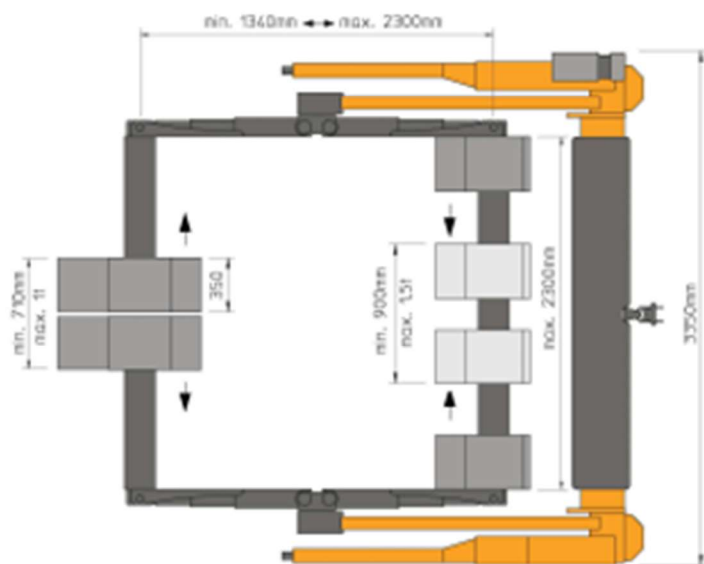

Pic. FHB3000-SS-2300 with ascending device FA-TORO



- Wheel support pads adjustable to suit wheel track and wheel base of the vehicle.
- Also suitable for three-wheeled-vehicles.
- Lift FHB3000 can be used either with swivel arms or with ascending device.
- Easy and quick refitting.

Mecagreen SAS • ZAC de la Roque Forcade • CD 908 • 13720 Belcodène • France

+33 3 74 09 56 70

max.p@mecagreen.fr • www.mecagreen.fr